

# Perkins Diesel Engines

Perkins engines are built many places around the globe and as such there are many variations of these engines. We will cover those commonly found in the United States.

Most Perkins engines built before 1980 have an SAE type mechanical tachometer drive fitting. This will work with our model 8901 sender and any standard tachometer.

After 1980, Perkins started leaving the fitting off of the engine. Our model 8875 Perkins tach drive adapter will replace the missing drive on the 4-236 and 6-354 engines. Installation is relatively simple. Remove the four cap screws that secure the 4" diameter plate to the front of the engine. This plate covers the gear that drives the fuel injector pump on the forward part of the port side of the engine.

The model 4-107 and 4-108 have an SAE tach drive located on the starboard side of the engine 3" aft of the alternator mount and below the water hose. On some the drive is a 0.104" square drive. Use our model 8104 drive pin in this instance.

The Perkins model 4-154 has no tach drive provision. Consider using our 8709 magnetic sensor kit.

*Perkins Corporation*

DATE	NO.	REV.	ISSUE	DATE

PERKINS DIESEL ENGINES

1. Remove the four cap screws that secure the 4" diameter plate to the front of the engine. This plate covers the gear that drives the fuel injector pump on the forward part of the port side of the engine.

2. Install the tach drive adapter (model 8875) on the gear.

3. Tighten the four cap screws to the specified torque.

4. Reconnect the tachometer cable to the adapter.

5. Test the tachometer operation.

6. If the tachometer does not operate, check the cable connection and the tachometer operation.

7. If the tachometer still does not operate, check the tachometer drive pin (model 8104) and the tachometer cable.

8. If the tachometer still does not operate, check the tachometer cable and the tachometer operation.

9. If the tachometer still does not operate, check the tachometer cable and the tachometer operation.

10. If the tachometer still does not operate, check the tachometer cable and the tachometer operation.



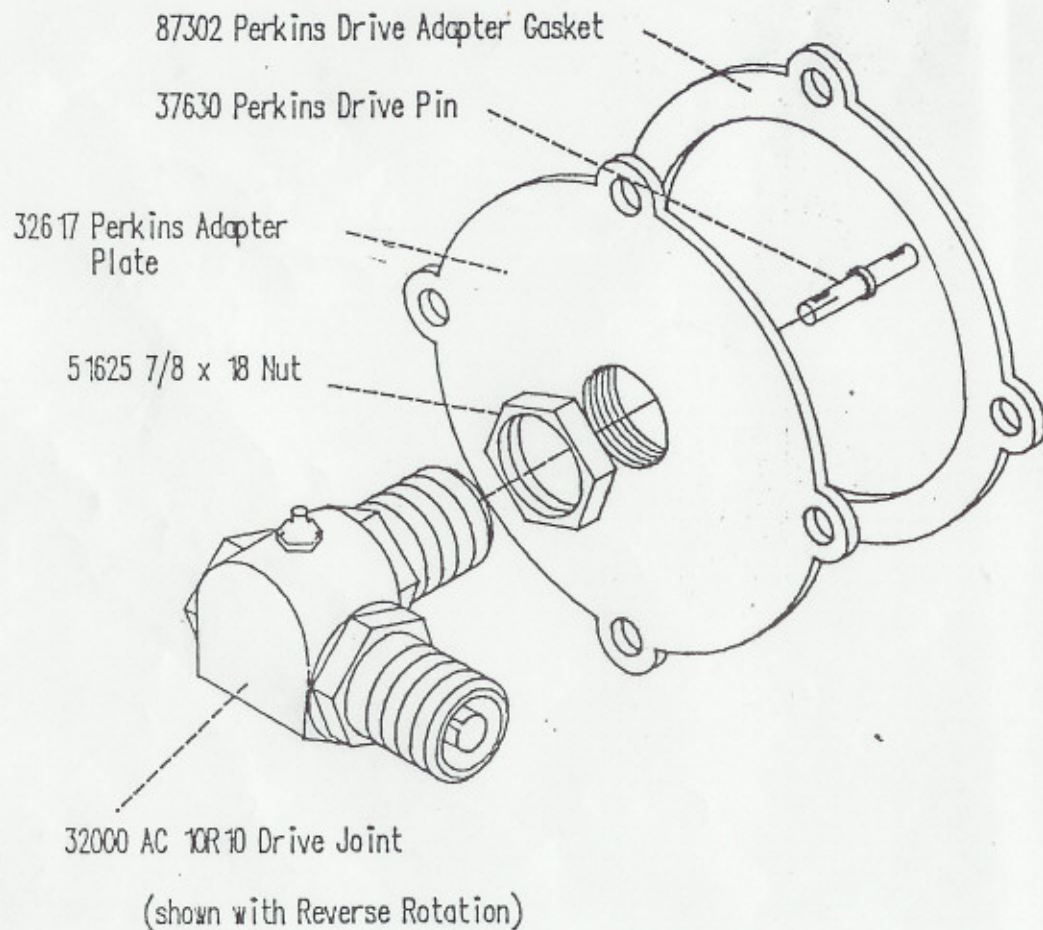

### Installation Instructions

NOTE: Drive adapter rotation may be varied by using 'D' direct and 'R' reverse drive adapters. Direction of rotation may be changed by switching drive adapters to suit drive cable routing to the synchronizer. See section E in the manual for drive cable connections.

NOTE: Please do not remove inside locknut from the threaded fitting as the adapter has a one half reduction ratio. This threaded end with the locknut should be towards the engine. Refer to section P in the manual for change of rotation procedure.

- 1) Mount Perkins Plate using 4 cap screws and new Gasket
- 2) Install Drive Pin halfway into the engine shaft and halfway into the Drive Joint.
- 3) Screw Drive Joint into plate until the end of the Drive Joint touches the engine gear. DO NOT FORCE.
- 4) Unscrew Drive Joint ONE FULL TURN. Any further Drive Joint adjustments should be made in the counter-clockwise direction.
- 5) Tighten Lock nut.

Perkins 6 / 354 Adapter

SCALE: NO

DATE: 10/1/88

PART # 06060

8875